

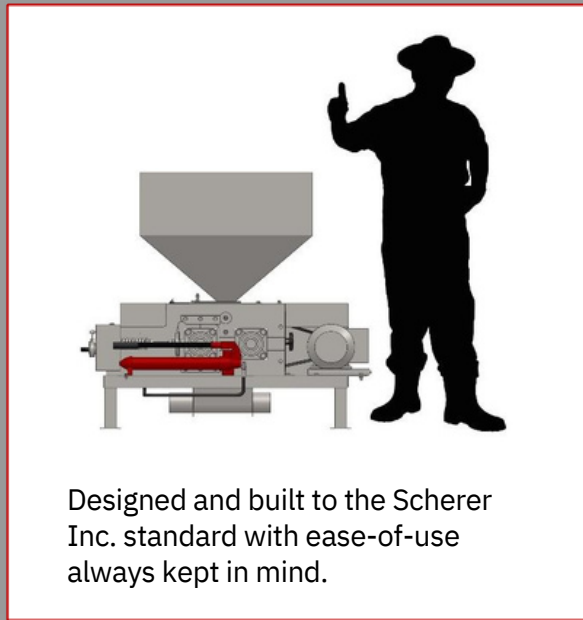

# Malt Mill

## 9 x 6 Single Roller-Mill



Designed and built to the Scherer Inc. standard with ease-of-use always kept in mind.

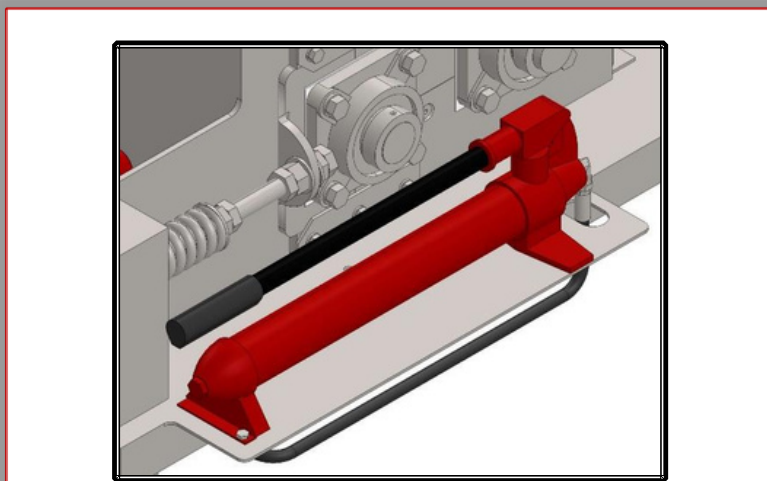
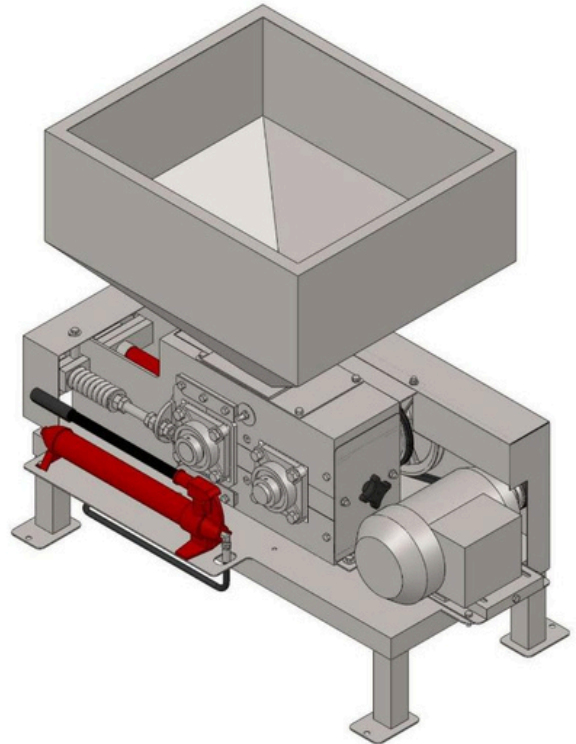

### Special Feature

Hydraulic roll opener allows for easy clearing of rolls and effortless resetting of roll gap after clearing.

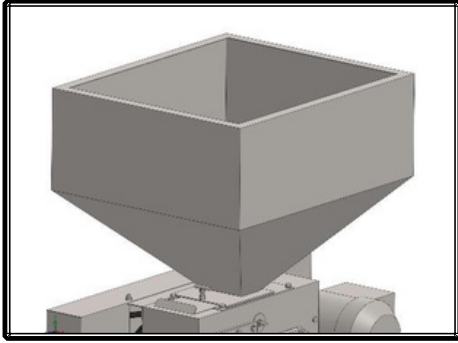

Large attached hopper built to hold 200 pounds

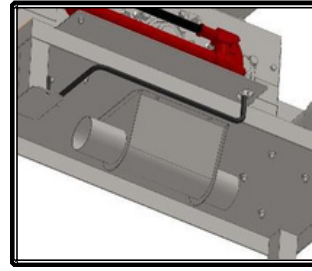

Adaptable discharge made to accept flex auger, rigid auger or even an extended stand to allow for filling bags by hand.

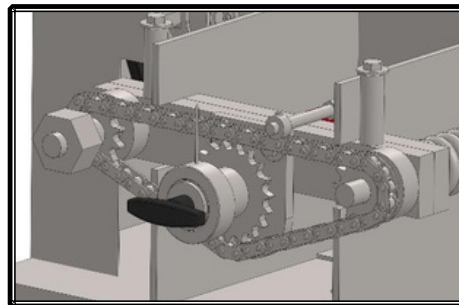

Easy single-action roller gap dial adjustment.

Scherer Inc.  
4940 W Foundation Court  
Sioux Falls, SD 57107  
800.883.9790  
[www.schererinc.com](http://www.schererinc.com)